

INSTRUCTION SHEET AERO BARS / TIME TRIAL CLIP-ONS - NOT FOR BAR END SHIFTERS -

The triathlon bar is mounted by means of the four clamps and the two aluminium bridges underneath the handlebar, just next to the stem. Make sure to use the plastic spacer blocks to position time trial bar correctly. Use our fitting paste supplied to avoid moving of the aero bar on the base bar when driving over potholes. **Do not move the clamps beyond the yellow marks** as the front section of the time trial bar has minimised wall thickness which is not designed to withstand the clamping forces! The two clamps with the long aluminium thread inserts must be mounted on the backside of the bar. Make sure the carbon tubes protrude **at least 3 mm** over the clamps!

Place the arm supports on the wide rear area of the aluminium bridges, insert the long titanium bolts into the drilled holes of these machined aluminium supports and tighten them nearly fully down into the long thread inserts of the rear carbon stays making sure the bolts heads go even with the angled surface of the arm supports while you do so (see left down). Turn the arm supports so as to make sure the 10° angle faces rear- and downwards. Slide the two bandages with their short threaded inserts about 60 mm onto the two carbon fibre tubes. Now apply our fitting paste to both the aluminium alloy bridge and the $\varnothing 25.8/31.7$ mm diameter cutout of the two delrin blocks and place the 24 mm diameter cutout towards the time trial bar. Insert the base handlebar between the aluminium alloy bridgepieces and the delrin counterpieces their diameter of 25.8/31.7 mm. Now insert the short titanium bolts into the holes of the semicircular front part of the aluminium bridges and tighten them up in the short thread inserts with **5 Nm as a maximum!** Grease the threads and the heads of the bolts before you do so!

Screw plastic arm support base to two of the four M5 thread inserts of the arm supports, **maximum torque there is 1.5 Nm!** Always turn both arm supports to their forward stops (making sure they stand vertically over the aluminium bridges) such as to **make sure the arm supports, after a short shock absorbing travel, come to be supported on the base handlebar!** Also the heads of the screws need to lie down even on the machined angled surface of the arm support (see left down)! Finally glue pads to arm supports.

Do not mount bar end shifters at to the upper ends of the bars! Carbon tubes may be shortened up to 10 mm on the short end and up to 30 on the longer end, using a standard metal saw.

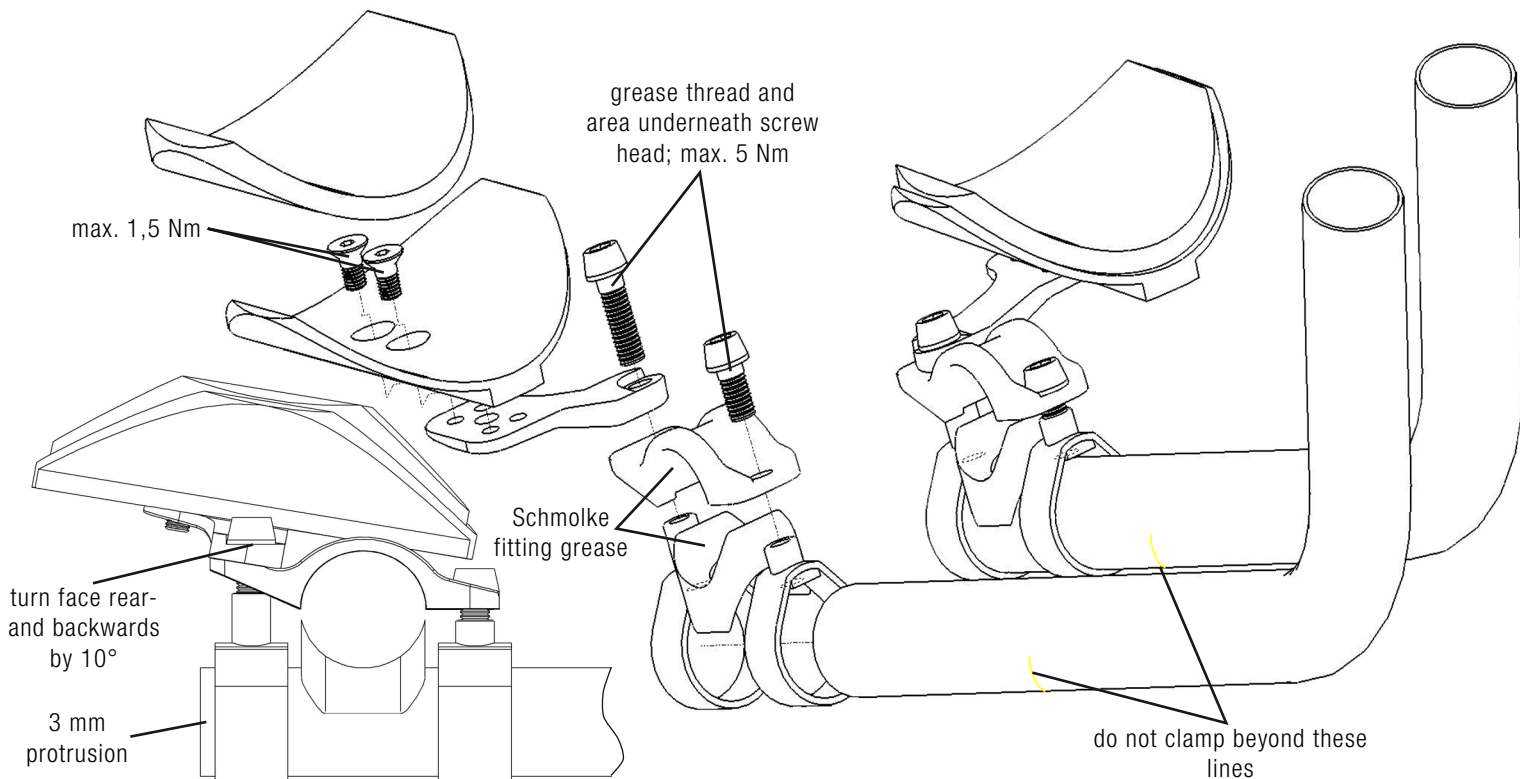

WARRANTY AERO BARS / TIME TRIAL CLIP-ONS

You have purchased a product Made in Germany, each and every handlebar is manufactured by hand and has passed a thorough final inspection. Ever since our first carbon fibre road bar came out in 1992 our products have been the benchmark for both weight and reliability. Our products have been tested and have received praise time and again. On top of that athletes have trusted us for their most important races. Jan Frodeno and Sabine Spitz have won the Gold medals in Triathlon and MTB in Beijing 2008 with Schmolke Products. Actually Daniel Unger and Christoph Sauser, as soon as the Topeak Ergon Team with Alban Lakata and Irina Kalentieva, or the Central Ghost Team with Sabine Spitz and Lisi Osl, as soon as the M.I.G. Team are using our handlebars and seatposts.

Our handlebars are computer designed with individual fibre layerings to meet your individual demands. We therefore consider our products strong and reliable enough to offer a free three year replacement warranty if our handlebars should fail due to a fault in material or manufacture within three years after the date of purchase.